

# UNION TOWNSHIP SECTION 26 R 13 TWP 8 MORGAN COUNTY, OHIO

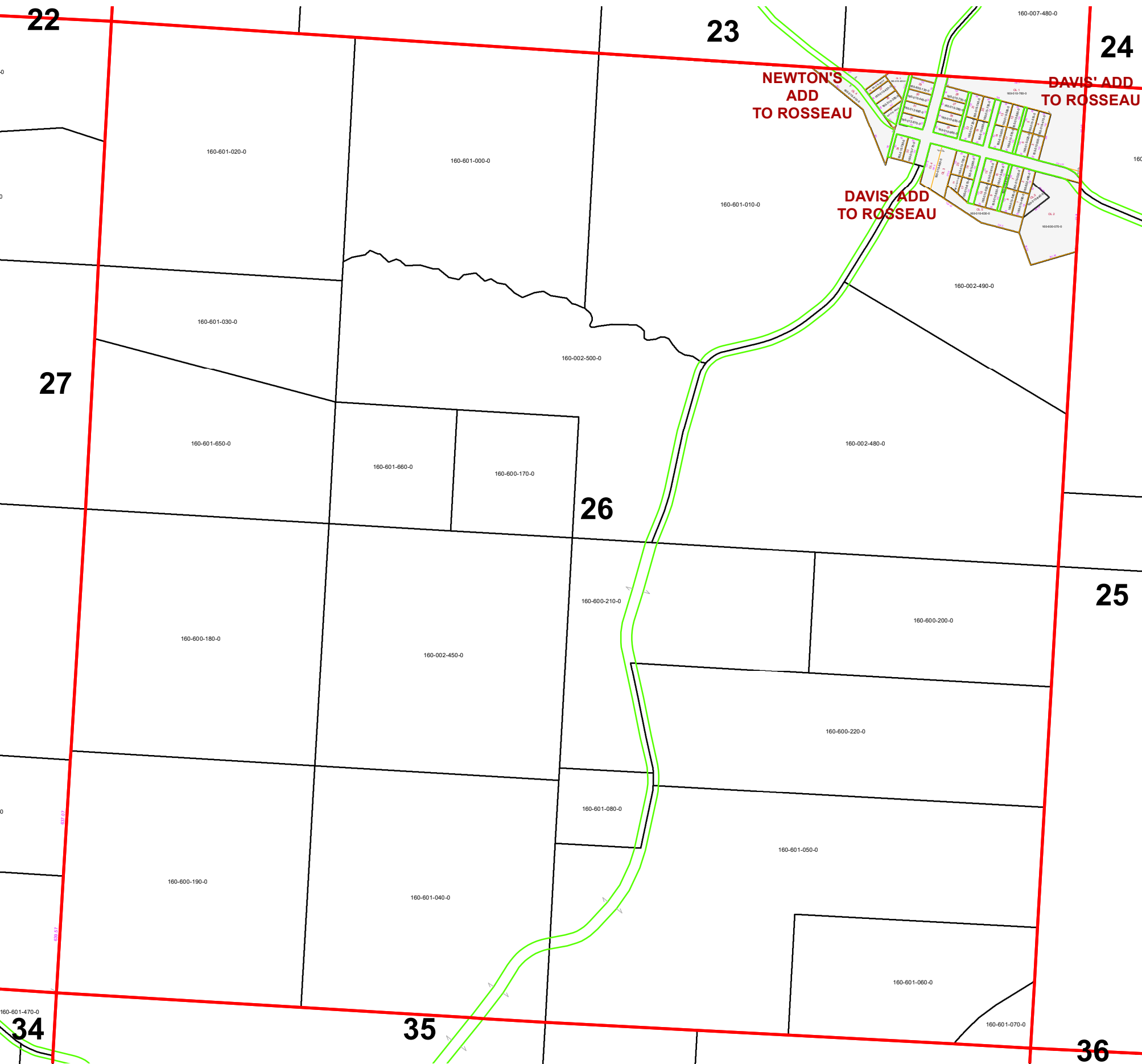

PIN	Owner	LegalDescr	Acres	VOL	PAGE	Survey_Ref	
160-002-500-0	HAMBEL FREDERICK	R13 T08 S26 SD 4-24	45.1	D.V	204	444	NoSurvey.pdf
160-002-450-0	HAMBEL FREDERICK & SEMIETZ DONN	R13 T08 S26 SD 12 NE Q	40	D.V	204	445	NoSurvey.pdf
160-002-480-0	REED DELORES	R13 T08 S26 SD 23	59.6	D.V	204	442	NoSurvey.pdf
160-002-490-0	REED DELORES	R13 T08 S26 SD 25	20	D.V	204	442	NoSurvey.pdf
160-601-070-0	STATE OF OHIO	R13 T08 S26 LOT 17	2	D.V	111	101	NoSurvey.pdf
160-601-040-0	STATE OF OHIO	R13 T08 S26 LOT 12 S E	40	D.V	111	101	NoSurvey.pdf
160-601-060-0	STATE OF OHIO	R13 T08 S26 LOT 16	20	D.V	111	101	NoSurvey.pdf
160-601-050-0	STATE OF OHIO	R13 T08 S26 LOT 13-14	65.3	D.V	111	500	NoSurvey.pdf
160-601-080-0	STATE OF OHIO	R13 T08 S26 LOT 22	4.7	D.V	111	500	NoSurvey.pdf
160-601-660-0	STATE OF OHIO	R13 T08 S26 S D 18	10	D.V	111	101	NoSurvey.pdf
160-601-650-0	STATE OF OHIO	R13 T08 S26 S D 9	22.5	D.V	136	664	NoSurvey.pdf
160-601-030-0	STATE OF OHIO	R13 T08 S26 LOT 8	16	D.V	102	527	NoSurvey.pdf
160-601-010-0	STATE OF OHIO	R13 T08 S26 LOT 5	60.22	D.V	102	527	NoSurvey.pdf
160-601-000-0	STATE OF OHIO	R13 T08 S26 LOT 3	20.4	D.V	102	527	NoSurvey.pdf
160-601-020-0	STATE OF OHIO	R13 T08 S26 LOT 7	40	D.V	102	527	NoSurvey.pdf
160-600-190-0	STATE OF OHIO DEPT OF NATURAL R	R13 T08 S26 LOT 11 FR	40	D.V	111	101	NoSurvey.pdf
160-600-220-0	STATE OF OHIO DEPT OF NATURAL R	R13 T08 S26 LOT 20-21	23.7	D.V	111	500	NoSurvey.pdf
160-600-200-0	STATE OF OHIO DEPT OF NATURAL R	R13 T08 S26 LOT 15	20	D.V	111	500	NoSurvey.pdf
160-600-210-0	STATE OF OHIO DEPT OF NATURAL R	R13 T08 S26 LOT 19 J L	25.3	D.V	111	500	NoSurvey.pdf
160-600-180-0	STATE OF OHIO DEPT OF NATURAL R	R13 T08 S26 LOT 10 J L	40	D.V	111	101	NoSurvey.pdf
160-600-170-0	STATE OF OHIO DEPT OF NATURAL R	R13 T08 S26 LOT 6 J L B	10	D.V	136	664	NoSurvey.pdf

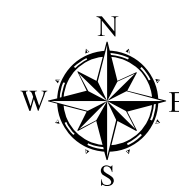

Boundaries	
	Hydro
	Section
	Roads
	Lot
	Township
	County
	Parcel
	ROW



Disclaimer: The information that these maps contains is for reference purposes only. Please bring any erros to the attention of the Engineer's Office staff. Thank you

Source: Morgan County Engineer's Office  
 Author: Marcia Wolfe  
 Date: 02/10/20

